



STATE OF NORTH CAROLINA
DEPARTMENT OF TRANSPORTATION

JOSH STEIN
GOVERNOR

DANIEL H. JOHNSON
SECRETARY

December 11, 2025

ADDENDUM NO. 1
Division Eleven

Contract No.: DK00439
WBS: DF18311.2005593.PR
County: Ashe
Location: Culvert #BP-005-2831 on SR 1577 (Jake Blackburn Road) Over Little Phoenix Creek
Type of Work: Grading, Drainage, Paving, and Structure
Bid Opening: December 18, 2025

To Whom It May Concern:

Reference is made to the plans and proposal furnished to you on this project. The following revisions have been made to the Transportation Management Plans:

Sheet No.	Revision
TMP-1C	Notes regarding Portable Concrete Guardrail and Temporary Guardrail was revised
TMP-2A	Removed
TMP-2B	Renumbered to TMP-2A
TMP-3	Temporary Guardrail added
TMP-4	Temporary Guardrail added

Please void the above listed Sheets in your plans and staple the revised Sheets thereto.

The following revisions have been made to the proposal:

Page No.	Revision
Proposal Cover	Note added that reads "Includes Addendum No. 1 Dated 12-11-2025"

Please void the above listed Pages in your proposal and staple the revised Pages thereto.

Mailing Address:
NC DEPT. OF TRANSPORTATION
DIVISION ELEVEN
P. O. BOX 250
NORTH WILKESBORO, NC 28659

Telephone: (336) 903-9101
Website: www.ncdot.org

Location:
NC DEPT. OF TRANSPORTATION
DIVISION ELEVEN
801 STATESVILLE RD
NORTH WILKESBORO, NC 28659

On the item sheets the following pay item revisions have been made:

<u>Item</u>	<u>Description</u>	<u>Old Quantity</u>	<u>New Quantity</u>
4465000000-N 1160	TEMPORARY CRASH CUSHIONS	2 EA	0
4470000000-N 1160	REMOVE & RESET TEMPORARY CRASH CUSHION	2 EA	0
4490000000-E 1170	PORTABLE CONCRETE BARRIER (ANCHORED)	290 LF	80 LF
4505000000-E 1170	REMOVE & RESECT CONCRETE BARRIER (ANCHORED)	230	0
3380000000-E 862	TEMPORARY STEEL BEAM GUARDRAIL	0	250
3382000000-E 862	TEMPORARY STEEL BEAM GUARDRAIL, SHOP CURVED	0	100
3387000000-N 862	TEMPORARY GUARDRAIL ANCHOR UNITS, TYPE B-77	0	2
3389150000-N 862	TEMPORARY GUARDRAIL END UNITS, TYPE TL-2	0	2
3389150000-N 862	TEMPORARY GUARDRAIL END UNITS, TYPE TL-3	0	2

The Contractor's bid must include these pay item revisions.

The electronic bidding file has been updated to reflect these revisions. Please download the Addendum File and follow the instructions for applying the addendum. Bid Express will not accept your bid unless the addendum has been applied.

The contract will be prepared accordingly.

Sincerely,



Bethany Elmore, PE
Division Contract Engineer

CC: Michael Poe, PE, Division Engineer
Brandon Whitaker, PE, Deputy Division Engineer
Ivan Dishman, PE, Division Construction Engineer
Matthew Evans, PE, Division Maintenance Engineer
Ramie Shaw, PE, Division Program Development Engineer
David Wayne, PE, District Engineer
Scott Pipes, PLS, Resident Engineer

STATE OF NORTH CAROLINA
DEPARTMENT OF TRANSPORTATION
HIGHWAY DIVISION 11

PROPOSAL

Includes Addendum No. 1 Dated 12-11-2025

DATE AND TIME OF BID OPENING: DECEMBER 18, 2025 AT 2:00 PM

CONTRACT ID: DK00439

WBS ELEMENT NO.: DF18311.2005593.PR

FEDERAL AID NO.: DF18311.2005593.PR

COUNTY: ASHE COUNTY

MILES: 0.035

ROUTE NO.: SR 1577 (JAKE BACKBURN ROAD)

**LOCATION: CULVERT #BP-005-2831 ON SR 1577 (JAKE BLACKBURN RD)
OVER LITTLE PHOENIX CREEK**

TYPE OF WORK: GRADING, DRAINAGE, PAVING, AND STRUCTURE

NOTICE:

ALL BIDDERS SHALL COMPLY WITH ALL APPLICABLE LAWS REGULATING THE PRACTICE OF GENERAL CONTRACTING AS CONTAINED IN CHAPTER 87 OF THE GENERAL STATUTES OF NORTH CAROLINA WHICH REQUIRES THE BIDDER TO BE LICENSED BY THE N.C. LICENSING BOARD FOR CONTRACTORS WHEN BIDDING ON ANY NON-FEDERAL AID PROJECT WHERE THE BID IS \$30,000 OR MORE, EXCEPT FOR CERTAIN SPECIALTY WORK AS DETERMINED BY THE LICENSING BOARD. BIDDERS SHALL ALSO COMPLY WITH ALL OTHER APPLICABLE LAWS REGULATING THE PRACTICES OF ELECTRICAL, PLUMBING, HEATING AND AIR CONDITIONING AND REFRIGERATION CONTRACTING AS CONTAINED IN CHAPTER 87 OF THE GENERAL STATUTES OF NORTH CAROLINA. NOTWITHSTANDING THESE LIMITATIONS ON BIDDING, THE BIDDER WHO IS AWARDED ANY FEDERAL - AID FUNDED PROJECT SHALL COMPLY WITH CHAPTER 87 OF THE GENERAL STATUTES OF NORTH CAROLINA FOR LICENSING REQUIREMENTS WITHIN 60 CALENDAR DAYS OF BID OPENING.

THIS IS A STRUCTURE PROJECT.

BID BOND IS REQUIRED.

NAME OF BIDDER

ADDRESS OF BIDDER

County: ASHE

Line #	Item Number	Sec #	Description	Quantity	Unit Cost	Amount
ROADWAY ITEMS						
0001	0000100000-N	800	MOBILIZATION	Lump Sum	L.S.	
0002	0000400000-N	801	CONSTRUCTION SURVEYING	Lump Sum	L.S.	
0003	0008000000-E	200	SUPPLEMENTARY CLEARING & GRUBBING	1 ACR		
0004	0036000000-E	225	UNDERCUT EXCAVATION	10 CY		
0005	0043000000-N	226	GRADING	Lump Sum	L.S.	
0006	0195000000-E	265	SELECT GRANULAR MATERIAL	50 CY		
0007	0196000000-E	270	GEOTEXTILE FOR SOIL STABILIZATION	100 SY		
0008	0199000000-E	SP	TEMPORARY SHORING	1,060 SF		
0009	0248000000-N	SP	GENERIC GRADING ITEM TYPE 1 APPROACH FILL, STA. -L- 12+13.00	Lump Sum	L.S.	
0010	0318000000-E	300	FOUNDATION CONDITIONING MATERIAL, MINOR STRUCTURES	10 TON		
0011	0321000000-E	300	FOUNDATION CONDITIONING GEOTEXTILE	20 SY		
0012	0448200000-E	310	15" RC PIPE CULVERTS, CLASS IV	20 LF		
0013	0448300000-E	310	18" RC PIPE CULVERTS, CLASS IV	36 LF		
0014	0995000000-E	340	PIPE REMOVAL	32 LF		
0015	1099700000-E	505	CLASS IV SUBGRADE STABILIZATION	50 TON		
0016	1220000000-E	545	INCIDENTAL STONE BASE	100 TON		
0017	1330000000-E	607	INCIDENTAL MILLING	40 SY		

County: ASHE

Line #	Item Number	Sec #	Description	Quantity	Unit Cost	Amount
0018	1491000000-E	610	ASPHALT CONC BASE COURSE, TYPE B25.0C	70 TON		
0019	1519000000-E	610	ASPHALT CONC SURFACE COURSE, TYPE S9.5B	100 TON		
0020	1575000000-E	620	ASPHALT BINDER FOR PLANT MIX	15 TON		
0021	1693000000-E	654	ASPHALT PLANT MIX, PAVEMENT REPAIR	10 TON		
0022	2286000000-N	840	MASONRY DRAINAGE STRUCTURES	2 EA		
0023	2366000000-N	840	FRAME WITH TWO GRATES, STD 840.24	1 EA		
0024	2367000000-N	840	FRAME WITH TWO GRATES, STD 840.29	1 EA		
0025	2556000000-E	846	SHOULDER BERM GUTTER	35 LF		
0026	3030000000-E	862	STEEL BEAM GUARDRAIL	75 LF		
0027	3045000000-E	862	STEEL BEAM GUARDRAIL, SHOP CURVED	50 LF		
0028	3150000000-N	862	ADDITIONAL GUARDRAIL POSTS	5 EA		
0029	3195000000-N	862	GUARDRAIL END UNITS, TYPE AT-1	1 EA		
0030	3215000000-N	862	GUARDRAIL ANCHOR UNITS, TYPE III	4 EA		
0031	3288000000-N	862	GUARDRAIL END UNITS, TYPE TL-2	2 EA		
0032	3360000000-E	863	REMOVE EXISTING GUARDRAIL	390 LF		
0033	3628000000-E	876	RIP RAP, CLASS I	70 TON		
0034	3656000000-E	876	GEOTEXTILE FOR DRAINAGE	320 SY		

County: ASHE

Line #	Item Number	Sec #	Description	Quantity	Unit Cost	Amount
0035	4400000000-E	1110	WORK ZONE SIGNS (STATIONARY)	258 SF		
0036	4405000000-E	1110	WORK ZONE SIGNS (PORTABLE)	144 SF		
0037	4424500000-N	SP	TEMPORARY PORTABLE TRAFFIC SIGNAL SYSTEM	1 EA		
0038	4430000000-N	1130	DRUMS	30 EA		
0039	4455000000-N	1150	FLAGGER	10 DAY		
0042	4490000000-E	1170	PORTABLE CONCRETE BARRIER (ANCHORED)	80 LF		
0044	4810000000-E	1205	PAINT PAVEMENT MARKING LINES (4")	1,458 LF		
0045	4835000000-E	1205	PAINT PAVEMENT MARKING LINES (24")	30 LF		
0046	4850000000-E	1205	REMOVAL OF PAVEMENT MARKING LINES (4")	1,618 LF		
0047	4870000000-E	1205	REMOVAL OF PAVEMENT MARKING LINES (24")	30 LF		
0048	4890000000-E	SP	GENERIC PAVEMENT MARKING ITEM INTEGRATED MULTIPOLYMER PAVEMENT MARKING LINES (4", 90 MILS)	1,513 LF		
0049	6000000000-E	1605	TEMPORARY SILT FENCE	585 LF		
0050	6006000000-E	1610	STONE FOR EROSION CONTROL, CLASS A	55 TON		
0051	6009000000-E	1610	STONE FOR EROSION CONTROL, CLASS B	20 TON		
0052	6012000000-E	1610	SEDIMENT CONTROL STONE	75 TON		
0053	6015000000-E	1615	TEMPORARY MULCHING	0.5 ACR		
0054	6018000000-E	1620	SEED FOR TEMPORARY SEEDING	100 LB		

County: ASHE

Line #	Item Number	Sec #	Description	Quantity	Unit Cost	Amount
0055	6021000000-E	1620	FERTILIZER FOR TEMPORARY SEEDING	0.5 TON		
0056	6024000000-E	1622	TEMPORARY SLOPE DRAINS	200 LF		
0057	6029000000-E	SP	SAFETY FENCE	260 LF		
0058	6030000000-E	1630	SILT EXCAVATION	40 CY		
0059	6036000000-E	1631	MATTING FOR EROSION CONTROL	545 SY		
0060	6037000000-E	1629	COIR FIBER MAT	100 SY		
0061	6038000000-E	SP	PERMANENT SOIL REINFORCEMENT MAT	150 SY		
0062	6042000000-E	1632	1/4" HARDWARE CLOTH	30 LF		
0063	6070000000-N	1639	SPECIAL STILLING BASINS	2 EA		
0064	6071002000-E	1642	FLOCCULANT	10 LB		
0065	6071010000-E	1642	WATTLE	30 LF		
0066	6071012000-E	1642	COIR FIBER WATTLE	80 LF		
0067	6071014000-E	1642	COIR FIBER WATTLE BARRIER	70 LF		
0068	6084000000-E	1660	SEEDING & MULCHING	0.5 ACR		
0069	6087000000-E	1660	MOWING	0.5 ACR		
0070	6090000000-E	1661	SEED FOR REPAIR SEEDING	50 LB		
0071	6093000000-E	1661	FERTILIZER FOR REPAIR SEEDING	0.25 TON		

County: ASHE

Line #	Item Number	Sec #	Description	Quantity	Unit Cost	Amount
0072	6096000000-E	1662	SEED FOR SUPPLEMENTAL SEEDING	50 LB		
0073	6108000000-E	1665	FERTILIZER TOPDRESSING	0.25 TON		
0074	6111000000-E	SP	IMPERVIOUS DIKE	300 LF		
0075	6114500000-N	1667	SPECIALIZED HAND MOWING	10 MHR		
0076	6117000000-N	1675	RESPONSE FOR EROSION CONTROL	25 EA		
0077	6117500000-N	SP	CONCRETE WASHOUT STRUCTURE	1 EA		
0078	6123000000-E	1670	REFORESTATION	0.1 ACR		
0079	6132000000-N	SP	GENERIC EROSION CONTROL ITEM PREFABRICATED CONCRETE WASHOUT	2 EA		
0095	3380000000-E	862	TEMPORARY STEEL BEAM GUARDRAIL	250 LF		
0096	3382000000-E	862	TEMPORARY STEEL BEAM GUARDRAIL, SHOP CURVED	100 LF		
0097	3387000000-N	862	TEMPORARY GUARDRAIL ANCHOR UNITS, TYPE ***** (B-77)	2 EA		
0098	3389150000-N	862	TEMPORARY GUARDRAIL END UNITS, TYPE ***** (TL-2)	2 EA		
0099	3389150000-N	862	TEMPORARY GUARDRAIL END UNITS, TYPE ***** (TL-3)	2 EA		
STRUCTURE ITEMS						
0080	8035000000-N	402	REMOVAL OF EXISTING STRUCTURE AT STATION ***** (REMOVAL OF EXISTING STRUCTURE)	Lump Sum	L.S.	
0081	8065000000-N	SP	ASBESTOS ASSESSMENT	Lump Sum	L.S.	

County: ASHE

Line #	Item Number	Sec #	Description	Quantity	Unit Cost	Amount
0082	8096000000-E	450	PILE EXCAVATION IN SOIL	25 LF		
0083	8097000000-E	450	PILE EXCAVATION NOT IN SOIL	50 LF		
0084	8121000000-N	412	UNCLASSIFIED STRUCTURE EXCAVATION AT STATION ***** (12+13.00)	Lump Sum	L.S.	
0085	8182000000-E	420	CLASS A CONCRETE (BRIDGE)	129.5 CY		
0086	8217000000-E	425	REINFORCING STEEL (BRIDGE)	18,680 LB		
0087	8328200000-E	450	PILE DRIVING EQUIPMENT SETUP FOR *** STEEL PILES (HP 12X53 STEEL PILES)	5 EA		
0088	8364000000-E	450	HP 12 X 53 STEEL PILES	100 LF		
0089	8505000000-E	460	VERTICAL CONCRETE BARRIER RAIL	100.25 LF		
0090	8608000000-E	876	RIP RAP CLASS II (2'-0" THICK)	360 TON		
0091	8622000000-E	876	GEOTEXTILE FOR DRAINAGE	401 SY		
0092	8657000000-N	430	ELASTOMERIC BEARINGS	Lump Sum	L.S.	
0093	8762000000-E	430	3'-0" X 1'-9" PRESTRESSED CONC CORED SLABS	450 LF		

1434/Dec11/Q31309.35/D424915738000/E95

Total Amount Of Bid For Entire Project :

GENERAL NOTES (CONT.)

PAVEMENT MARKINGS AND MARKERS

U) INSTALL TEMPORARY PAVEMENT MARKINGS AND TEMPORARY PAVEMENT MARKERS ON INTERIM LAYERS OF PAVEMENT AS FOLLOWS:

ROAD NAME	MARKING	MARKER
JAKE BLACKBURN RD	PAINT	N/A
OLD HIGHWAY 16	PAINT	N/A

V) TIE PROPOSED PAVEMENT MARKING LINES TO EXISTING PAVMENT MARKING LINES.

W) REPLACE ANY PAVEMENT MARKING LINES THAT HAVE BEEN DAMAGED BY THE END OF EACH DAY'S OPERATION.

X) PLACE ONE APPLICATION OF PAINT FOR TEMPORARY TRAFFIC PATTERNS. PLACE A SECOND APPLICATION OF PAINT SIX (6) MONTHS AFTER THE INITIAL APPLICATION AND EVERY SIX MONTHS AS DIRECTED BY THE ENGINEER.

Y) REMOVE/REPLACE ANY CONFLICTING/DAMAGED PAVEMENT MARKINGS AND MARKERS BY THE END OF EACH DAY'S OPERATION.

MISCELLANEOUS

Z) LAW ENFORCEMENT MAY BE USED TO MAINTAIN TRAFFIC THROUGH THE WORK AREA AND/OR INTERSECTIONS, AS DIRECTED BY THE ENGINEER.

AA) IN THE EVENT A TIE-IN CANNOT BE MADE IN ONE DAY'S TIME, BRING THE TIE-IN AREA TO AN APPROPRIATE ROADWAY ELEVATION AS DETERMINED BY THE ENGINEER. PLACE BLACK ON ORANGE "LOOSE GRAVEL" SIGNS (W8-7) AND BLACK ON ORANGE "PAVEMENT ENDS" SIGNS (W8-3) AND RESPECTIVELY IN ADVANCE OF THE UNEVEN AREAS. USE DRUMS TO DELINEATE THE EDGE OF ROADWAY ALONG UNPAVED AREAS.

PHASING

WHILE MAINTAINING TRAFFIC USING RSD 1101.02 FOR LANE CLOSURES AS NECESSARY, PERFORM THE FOLLOWING AS SHOWN ON SHEETS TMP-3 AND TMP-4. LANE CLOSURES ARE REQUIRED ANYTIME PERSONNEL OR EQUIPMENT ARE WORKING WITHIN FIVE FEET OF A TRAVEL LANE.

PHASE 1

STEP 1: PRIOR TO BEGINING CONSTRUCTION, INSTALL ADVANCE WARNING SIGNS ALONG SR 1577 (JAKE BLACKBURN RD) AND SR 1573 (OLD HWY 16) AS SHOWN ON RSD. 1101.01 SHEET 3 OF 3.
 STEP 2: UTILIZING FLAGGING FOR A TEMPORARY LANE CLOSURE AS SHOWN ON RSD. 1101.02 SHEET 1 OF 19, INSTALL DRAINAGE STRUCTURES 403 TO 404 AND 1' OF TEMPORARY PAVEMENT AND 3' OF GRADED SHOULDER ALONG -EL- STA. 10+83.00 TO STA. 12+25.00, AS SHOWN IN PLANS.
 STEP 3: INSTALL ADVANCE WORK SIGNS FOR A PORTABLE TEMPORARY SIGNAL IN ACCORDANCE WITH RSD 1101.02 SHEET 17 OF 19 AND COVER.
 STEP 4: INSTALL TEMPORARY GUARDRAIL, TEMPORARY END UNITS, TEMPORARY PAVEMENT MARKINGS, AND REMOVE CONFLICTING PAVEMENT MARKINGS. ACTIVATE PORTABLE TEMPORARY SIGNALS AND PLACE TRAFFIC ONTO TEMPORARY PATTERN AS SHOWN IN TMP-3.

INTERMEDIATE CONTRACT TIME #2:
 THE COMPLETION DATE FOR THE WORK ASSOCIATED WITH PHASE 1, STEPS 5 & 6 IS 90 CONSECUTIVE CALENDER DAYS AFTER AND INCLUDING THE DATE THAT THE CONTRACTOR COMPLETES PHASE 1, STEP 4. REFER TO THE PROJECT SPECIFICATIONS FOR LIQUIDATED DAMAGES.

STEP 5: AWAY FROM TRAFFIC, INSTALL THE TEMPORARY SHORING AS SHOWN ON TMP-3.
 STEP 6: AWAY FROM TRAFFIC, BEGIN CONSTRUCTION ON THE ROADWAY AND BRIDGE AS SHOWN ON TMP-3, INCLUDING BUT NOT LIMITED TO PIPE AND HEADWALL REMOVAL, BRIDGE CONSTRUCTION, DRAINAGE, GRADING, MILLING, WEDGING, PAVEMENT REMOVAL AND GUARDRAIL UP TO BUT NOT INCLUDING THE FINAL LAYER OF ASPHALT SURFACE COURSE.

PHASE 2

STEP 1: WHILE MAINTAINING TRAFFIC IN THE PHASE 1 TEMPORARY PATTERN, INSTALL PORTABLE CONCRETE BARRIER AND TEMPORARY GUARDRAIL ON THE NEWLY CONSTRUCTED BRIDGE AS SHOWN ON SHEET TMP-4 THAT DOES NOT CONFLICT WITH THE PHASE 1 PORTABLE CONCRETE BARRIER.
 STEP 2: ADJUST TEMPORARY PAVEMENT MARKINGS AND SHIFT TRAFFIC ONTO PATTERN SHOWN IN TMP-4.

INTERMEDIATE CONTRACT TIME #3:
 THE COMPLETION DATE FOR THE WORK ASSOCIATED WITH PHASE 2, STEP 3 IS 60 CONSECUTIVE CALENDER DAYS AFTER AND INCLUDING THE DATE THAT THE CONTRACTOR COMPLETES PHASE 2, STEP 2. REFER TO THE PROJECT SPECIFICATIONS FOR LIQUIDATED DAMAGES.



STEP 3: AWAY FROM TRAFFIC, CONSTRUCT THE ROADWAY AND BRIDGE AS SHOWN ON TMP-4, INCLUDING BUT NOT LIMITED TO TEMPORARY SHORING REMOVAL, PIPE REMOVAL, BRIDGE CONSTRUCTION, DRAINAGE, GRADING, MILLING, WEDGING, PAVEMENT REMOVAL, AND GUARDRAIL UP TO BUT NOT INCLUDING THE FINAL LAYER OF ASPHALT SURFACE COURSE.

PHASE 3

STEP 1: REMOVE TRAFFIC CONTROL DEVICES INSTALLED IN PHASE 2, INSTALL TEMPORARY PAVEMENT MARKINGS IN THE FINAL PATTERN AS SHOWN ON PAVEMENT MARKINGS PLANS, AND SHIFT TRAFFIC INTO THE FINAL PATTERN.
 STEP 2: UTILIZING RSD. 1101.02 SHEET 1 OF 19 FOR TEMPORARY LANE CLOSURES, PLACE THE FINAL ASPHALT SURFACE COURSE AND FINAL PAVEMENT MARKINGS AND MARKERS.
 STEP 3: REMOVE ALL TRAFFIC CONTROL DEVICES AND OPEN ALL LANES TO TRAFFIC.

DOCUMENT NOT CONSIDERED FINAL
 UNLESS ALL SIGNATURES COMPLETED

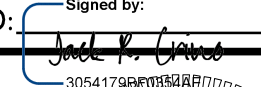

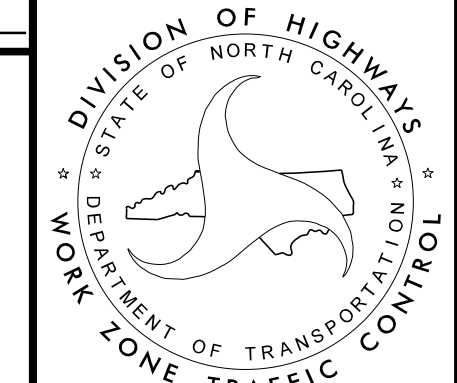
APPROVED:  DATE: 11/14/2025 		GENERAL AND PHASING NOTES
---	---	------------------------------

TEMPORARY SHORING NOTES

**TEMPORARY SHORING RECOMMENDATIONS
DATED SEPTEMBER 10, 2025
FROM FALCON ENGINEERING**

1. **FOR TEMPORARY SHORING AND POSITIVE PROTECTION FOR TEMPORARY SHORING, SEE PLANS AND TEMPORARY SHORING PROVISION.**
2. **BEFORE BEGINNING TEMPORARY SHORING DESIGN OR CONSTRUCTION, SURVEY EXISTING GROUND ELEVATIONS IN THE VICINITY OF SHORING LOCATIONS TO DETERMINE ACTUAL SHORING HEIGHTS.**
3. **DESIGN TEMPORARY SHORING FROM -L- STATION 11+79, 7.5' LT TO STATION 12+32, 7.5' LT FOR THE FOLLOWING ASSUMED SOIL PARAMETERS AND GROUNDWATER ELEVATION:**

ABOVE ELEVATION 2,649 (ROADWAY EMBANKMENT OR ALLUVIAL SOIL)
UNIT WEIGHT (GAMMA) = 120 LB/CF
FRICTION ANGLE (f) = 30 DEGREES
COHESION (c) = 0 LB/SF

BELOW ELEVATION 2,649 (WEATHERED ROCK OR ROCK)
UNIT WEIGHT (GAMMA) = 140 LB/CF
FRICTION ANGLE (F) = 45 DEGREES
COHESION (c) = 0 LB/SF
GROUNDWATER ELEVATION = 2,654 FT
4. **DRIVEN PILING FOR TEMPORARY SHORING FROM 11+79, 7.5' LT TO STATION 12+32, 7.5' LT WILL NOT PENETRATE BELOW ELEVATION 2,649 FT DUE TO OBSTRUCTIONS, VERY DENSE OR HARD SOIL, BOULDERS OR WEATHERED OR HARD ROCK.**
5. **IT MAY BE PREFERRED TO USE A TEMPORARY SOIL NAIL WALL FOR TEMPORARY SHORING FROM 11+79, 7.5' LT TO STATION 12+32, 7.5' LT. FOR TEMPORARY SOIL NAIL WALLS, SEE TEMPORARY SOIL NAIL WALLS PROVISION.**

Kimley»Horn

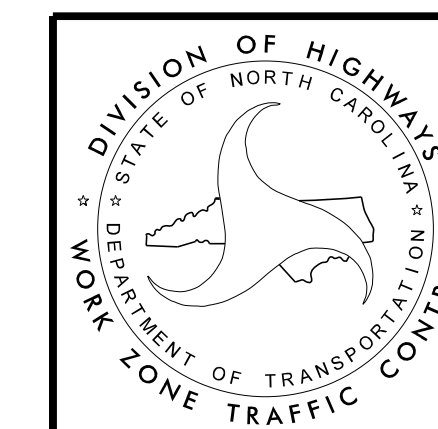

**TEMPORARY
SHORING NOTES**

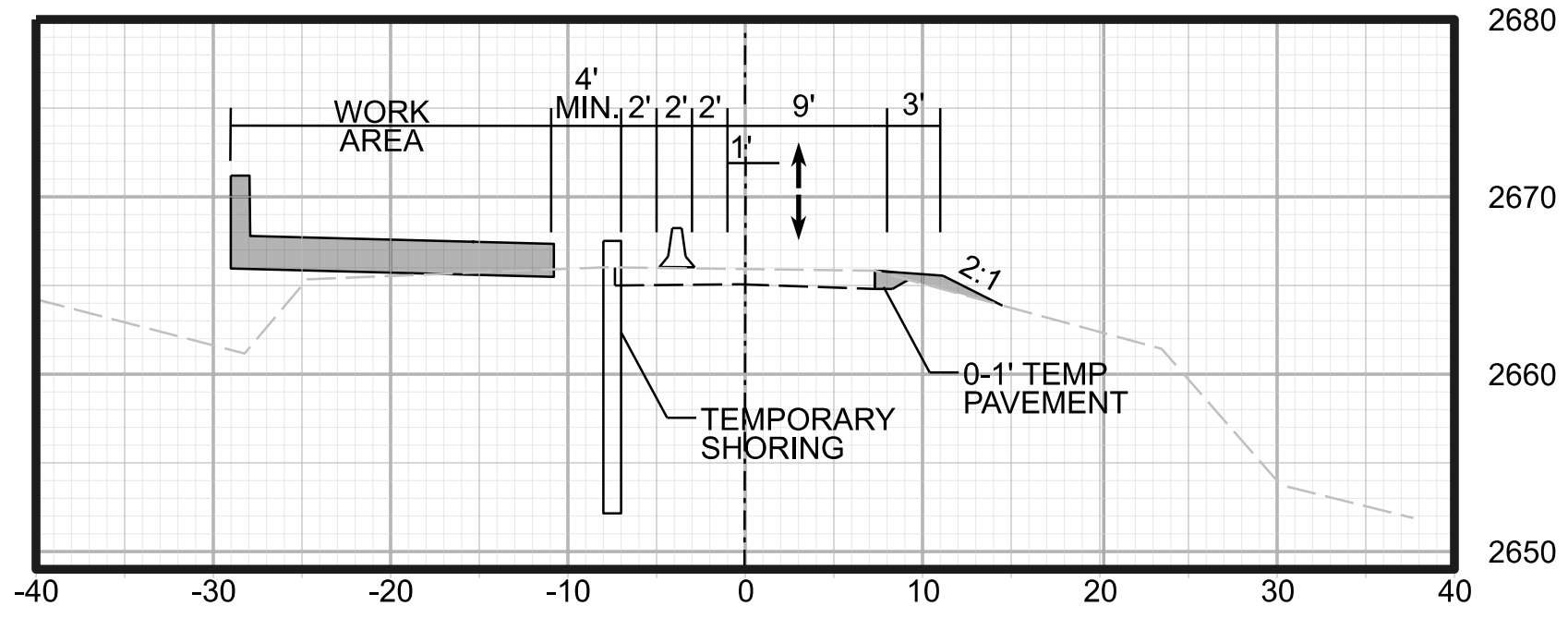

-EL-
11+88.00
SECTION A-A

POSSIBLE SHORING LOCATIONS						
SHORING ID NO.	BEGIN STA. & OFFSET REF	END STA. & OFFSET REF	SHORING TYPE	EST. AVG. SHORING HT.	MAX SHORING HT.	REFERENCE DATA SOURCE
1	-EL- 11+79 +/- (7.5 +/- LEFT)	-EL- 12+32 +/- (7.5 +/- LEFT)	ROADWAY	20 FT.	20 FT.	TMP-2 SHEET

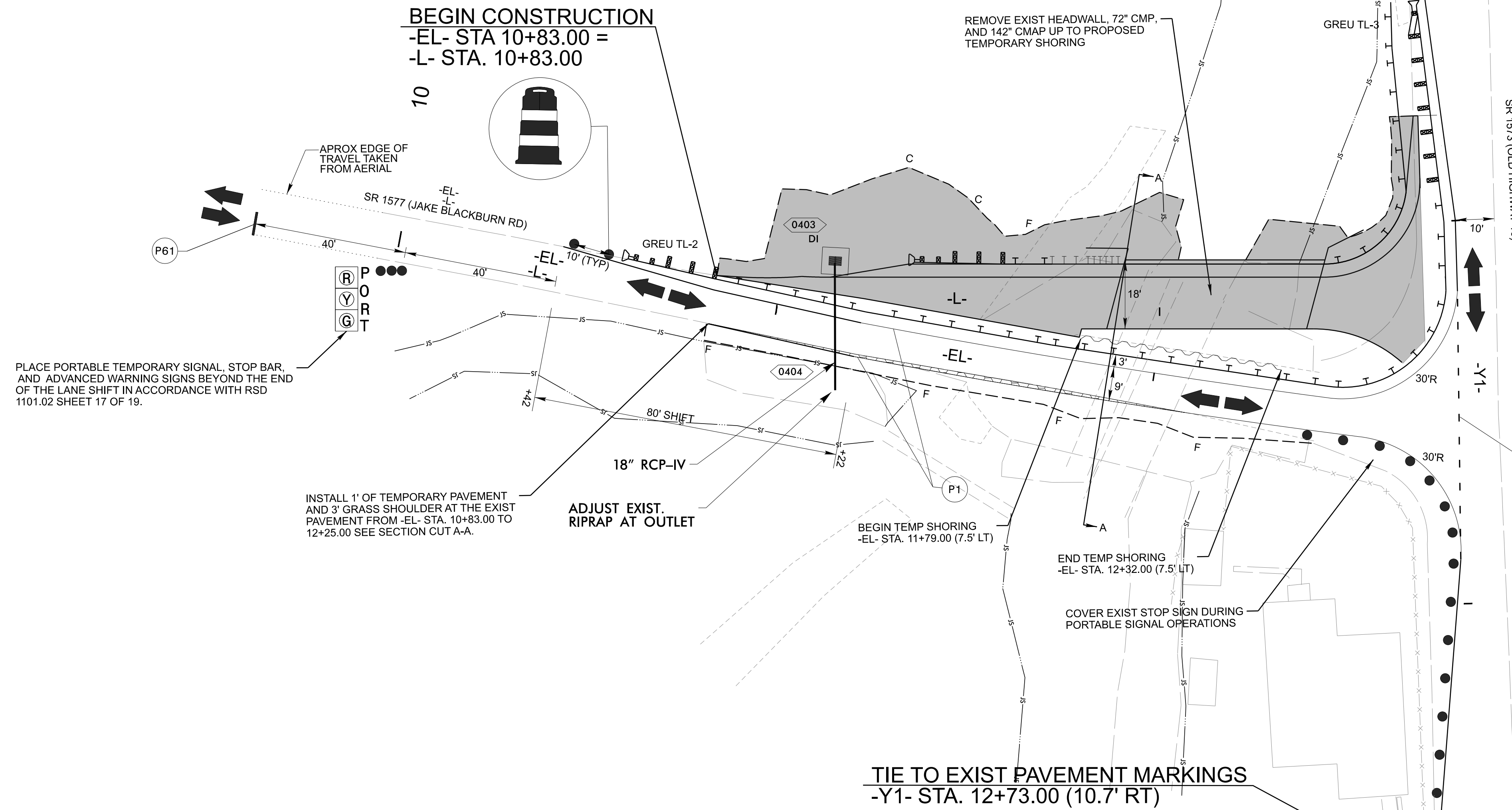

PLACE PORTABLE TEMPORARY SIGNAL, STOP BAR, AND ADVANCED WARNING SIGNS BEYOND THE END OF THE LANE SHIFT IN ACCORDANCE WITH RSD 1101.02 SHEET 17 OF 19.

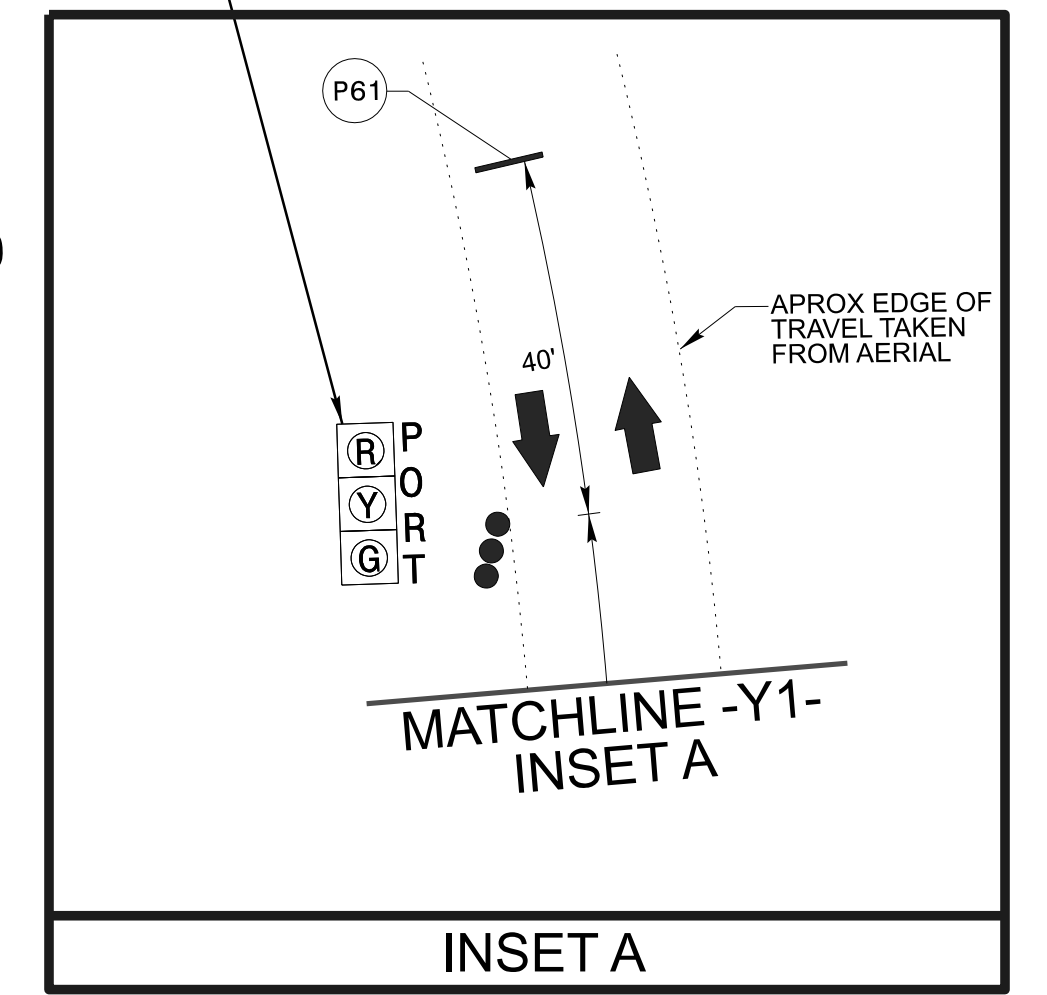
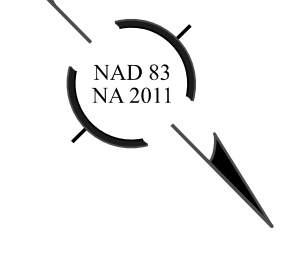

10

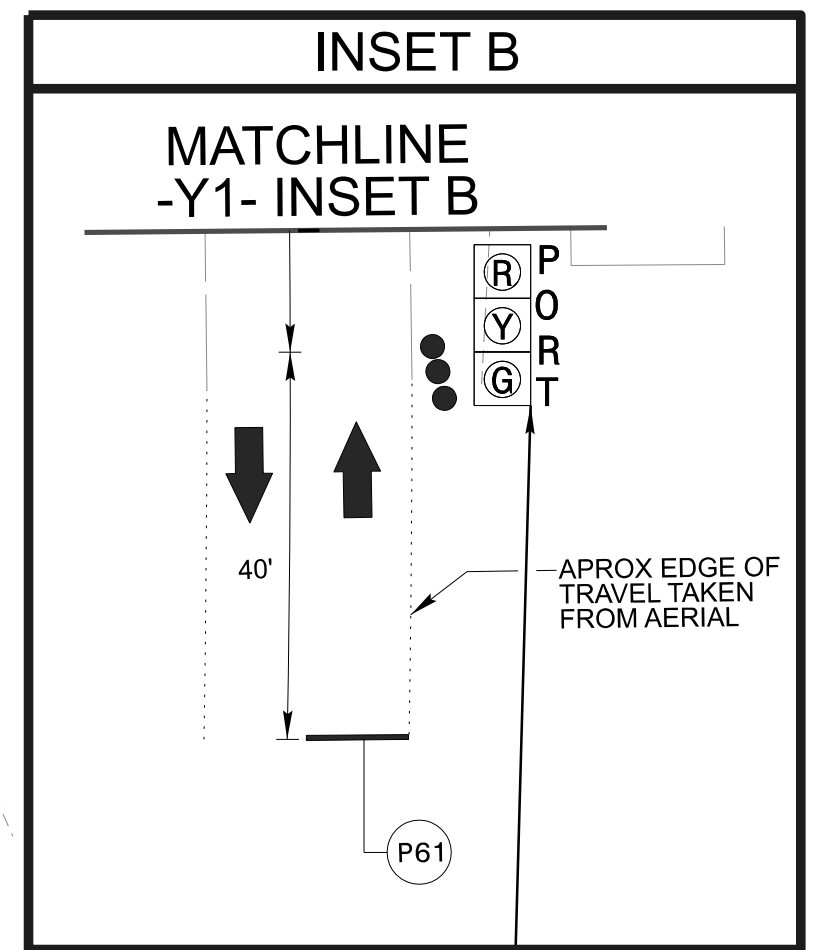

PLACE PORTABLE TEMPORARY SIGNAL, STOP BAR, AND ADVANCED WARNING SIGNS BEYOND THE END OF THE LANE SHIFT IN ACCORDANCE WITH RSD 1101.02 SHEET 17 OF 19.

**DOCUMENT NOT CONSIDERED FINAL
UNLESS ALL SIGNATURES COMPLETED**



APPROVED: *Jack R. Crino* DATE: 12/10/2025

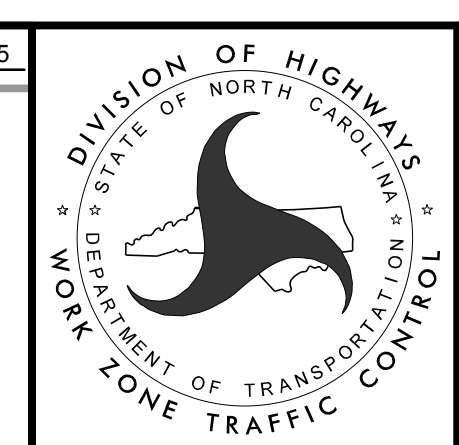

PHASE I DETAIL

PROJ. REFERENCE NO.	SHEET NO.
DF18311.2005593.PR	TMP-4

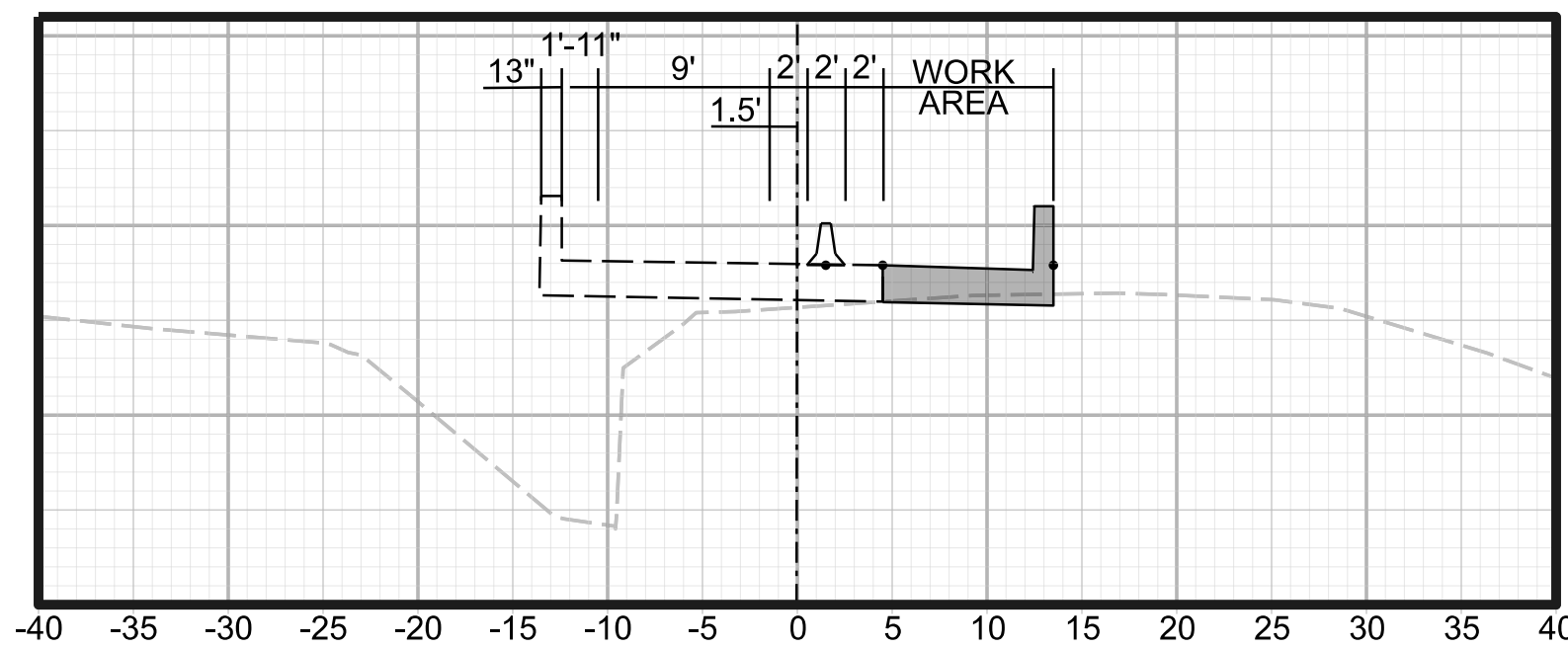

-L-
12+00.00
SECTION B-B

TIE TO EXIST PAVEMENT MARKINGS
-Y1- STA. 10+05.00 (10' RT)

END CONSTRUCTION
-Y1- STA. 10+42.00

BEGIN CONSTRUCTION
TIE TO EXISTING
-L- STA. 10+83.00

PLACE PORTABLE TEMPORARY SIGNAL, STOP BAR, AND ADVANCED WARNING SIGNS BEYOND THE END OF THE LANE SHIFT IN ACCORDANCE WITH RSD 1101.02 SHEET 17 OF 19.

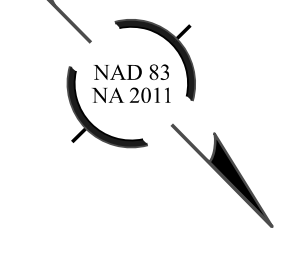

10

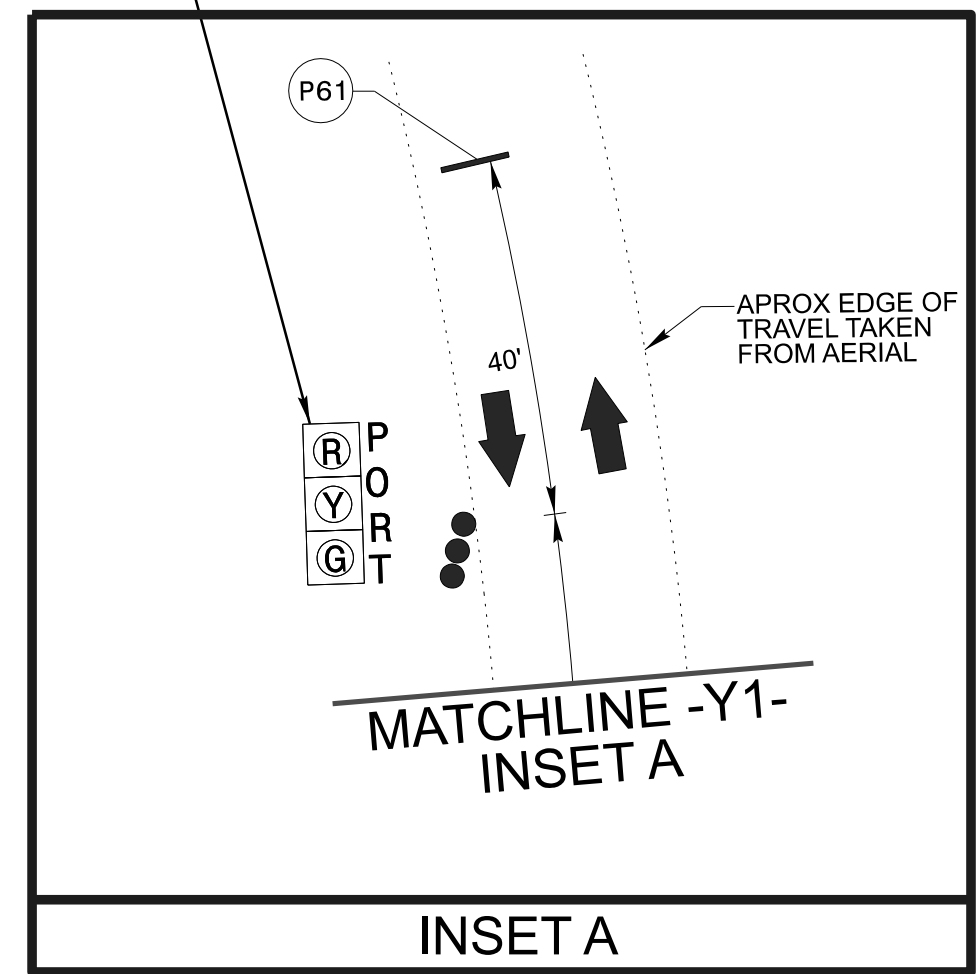

PLACE PORTABLE TEMPORARY SIGNAL, STOP BAR, AND ADVANCED WARNING SIGNS BEYOND THE END OF THE LANE SHIFT IN ACCORDANCE WITH RSD 1101.02 SHEET 17 OF 19.

REMOVE EXIST 72" CMP AND 142" CMAP

TIE TO EXIST PAVEMENT MARKINGS
-Y1- STA. 12+73.00 (10.7' RT)

+78

95' SHIFT

+73

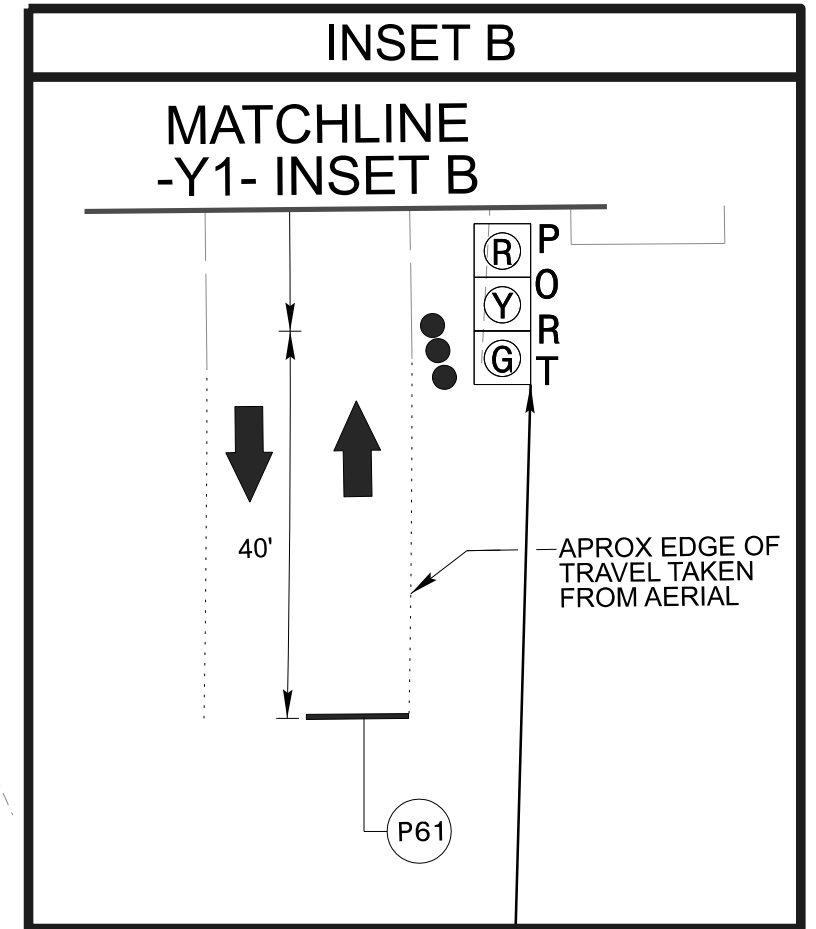

PLACE PORTABLE TEMPORARY SIGNAL, STOP BAR, AND ADVANCED WARNING SIGNS BEYOND THE END OF THE LANE SHIFT IN ACCORDANCE WITH RSD 1101.02 SHEET 17 OF 19.

DOCUMENT NOT CONSIDERED FINAL
UNLESS ALL SIGNATURES COMPLETED

Kimley»Horn

APPROVED: *Jack R. Crino* DATE: 12/10/2025

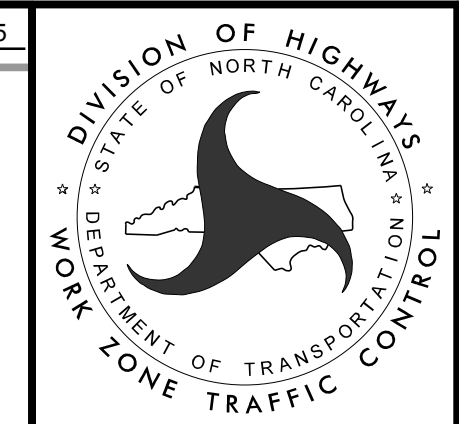

PHASE II DETAIL